

Line Between Donation and Depreciation Lands

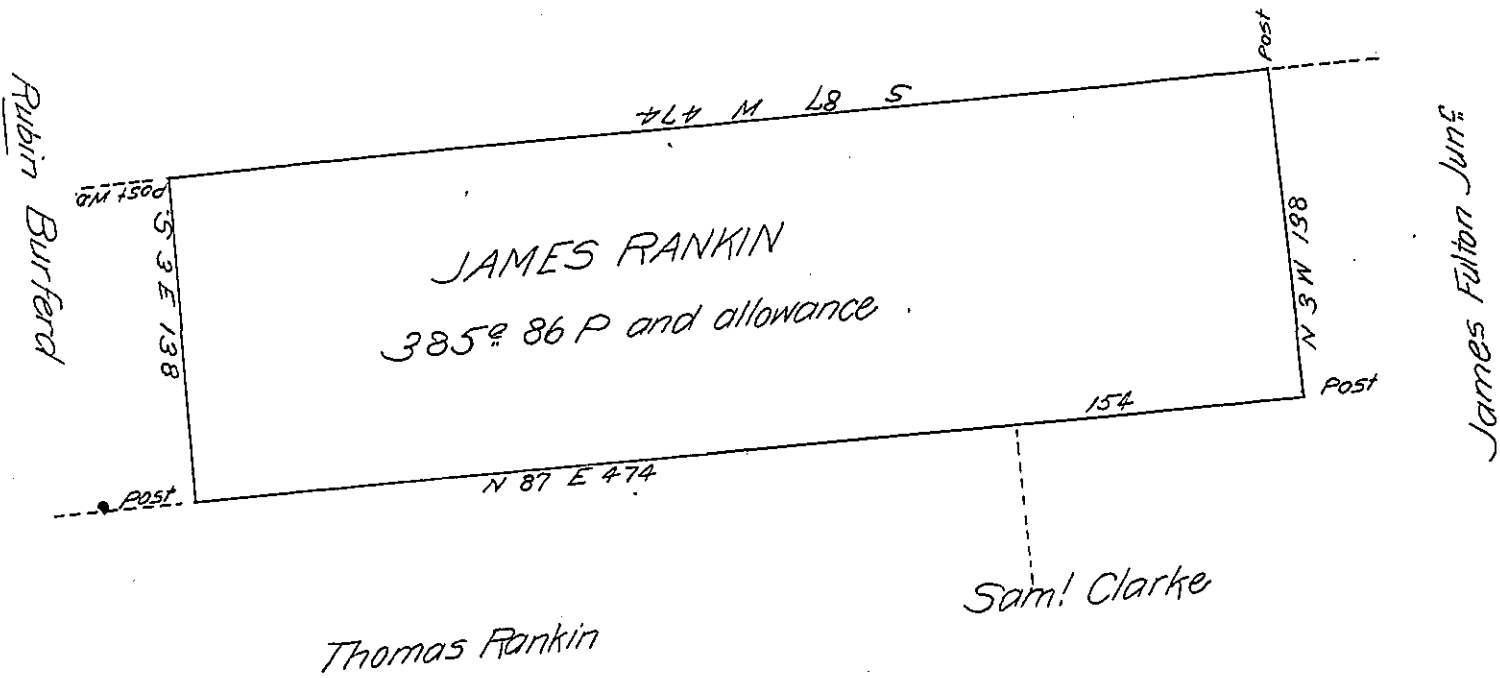

A Draught of a tract of Land Situate on the Waters of Buffalee Creek in Armstrong County Con-
 taining three hundred Eighty five Acres 86 P and Allowance of Six P. Cent for Roads &c.
 Surveyed on the 3rd day of December 1808 by Virtue of a Warrant Granted to James Rankin
 Dated April 21st 1794 for 400 Acres

To Samuel Cochran Esq: S.G.

Geo. Ross D.S.

IN TESTIMONY that the above is a copy of the original remaining on file in
 the Department of Internal Affairs of Pennsylvania, made
 conformably to an Act of Assembly approved the 16th day of
 February, 1833, I have hereunto set my Hand and caused
 the Seal of said Department to be affixed at Harrisburg,
 this twentyeight day of August 1906

Geo. P. Brown
 Secretary of Internal Affairs.